

TOILET ROOM SURROUNDING MATERIALS NOTES:

FLOORS:
TOILET AND BATHING ROOM FLOORS SHALL HAVE A SMOOTH, HARD, NON-ABSORBANT SURFACE THAT EXTENDS UPWARD ONTO THE WALLS A MINIMUM OF 6".

WALLS:
WALLS WITHIN 2 FEET OF URINALS AND TOILETS SHALL HAVE A SMOOTH, HARD, NON-ABSORBANT SURFACE TO A HEIGHT OF 4 FEET ABOVE THE FLOOR, AND EXCEPT FOR STRUCTURAL ELEMENTS, THE MATERIALS USED IN SUCH WALLS SHALL BE OF A TYPE THAT IS NOT ADVERSELY AFFECTED BY MOISTURE.

ACCESSORIES:
GRAB BARS, TOWEL BARS, PAPER DISPENSERS AND SOAP DISHES, PROVIDED ON OR WITHIN WALLS, SHALL BE INSTALLED AND SEALED TO PROTECT STRUCTURAL ELEMENTS FROM MOISTURE.

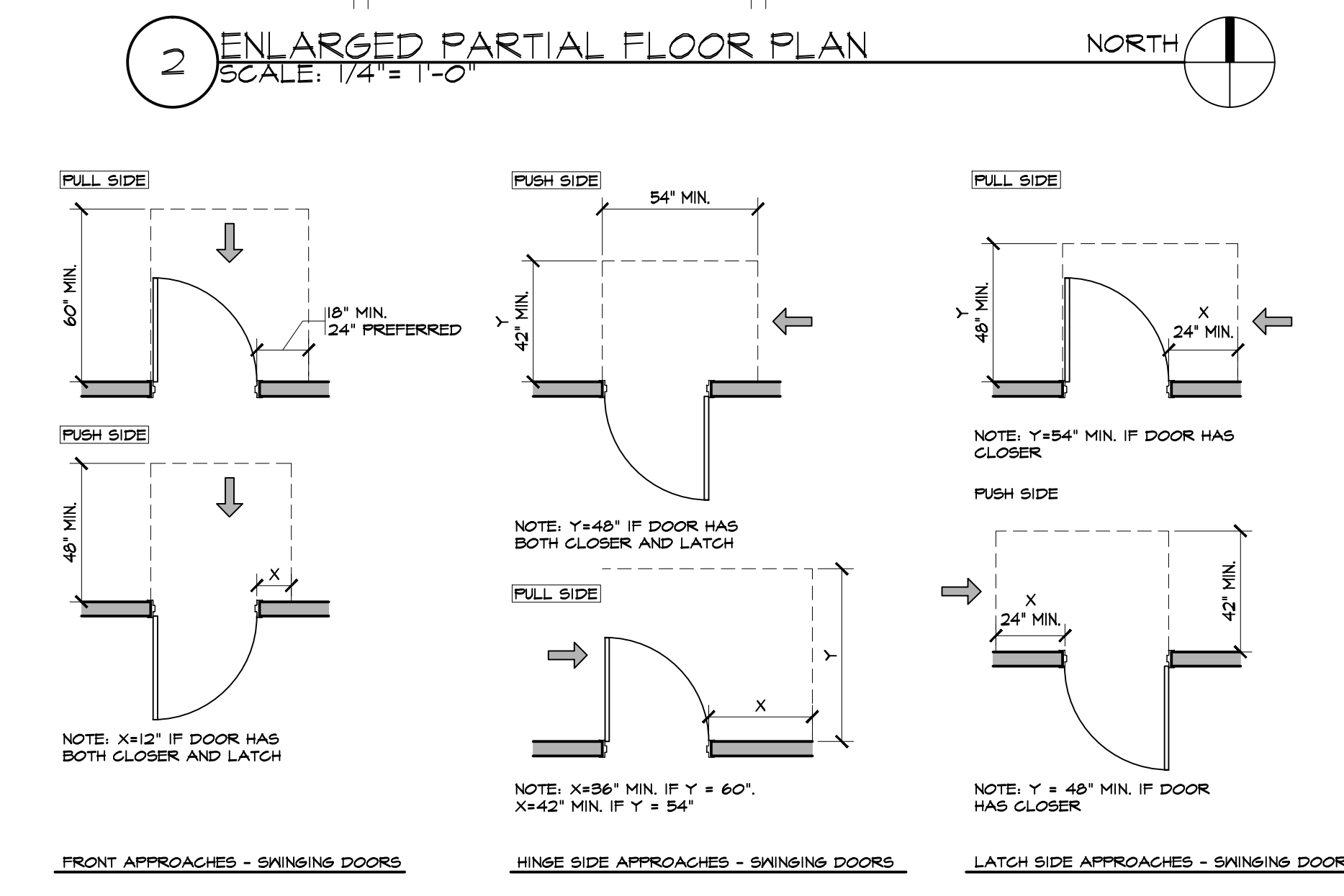
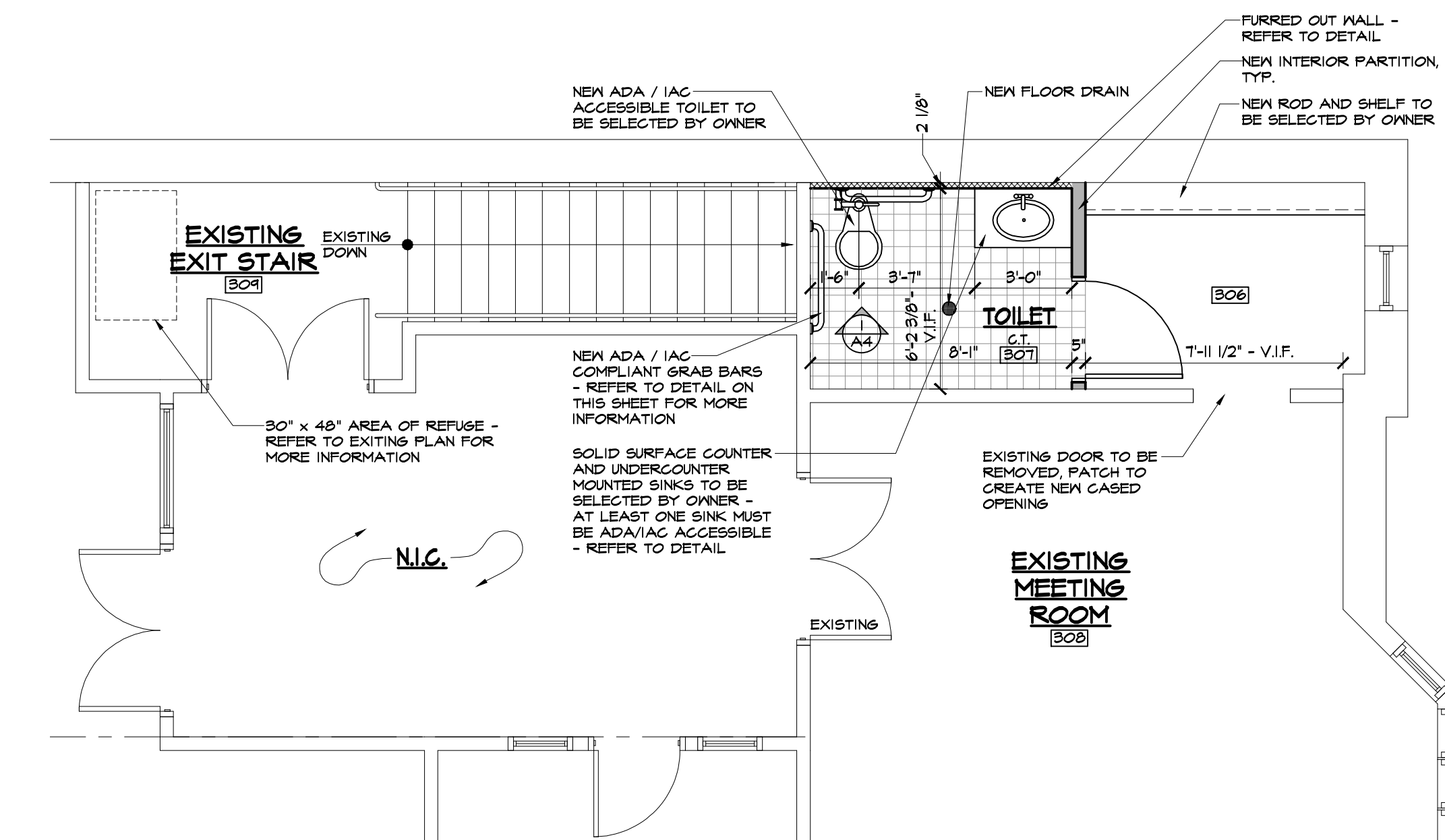
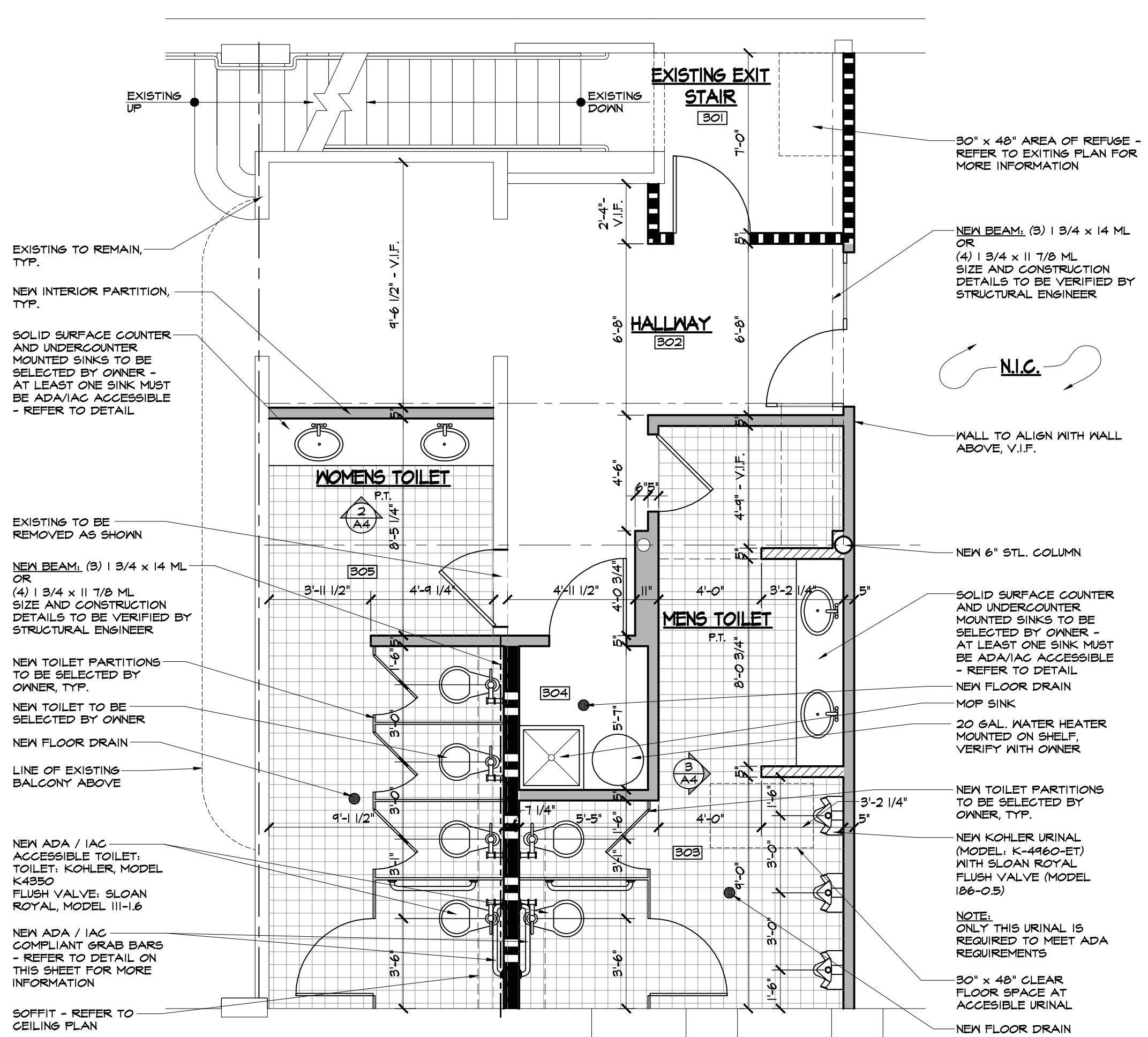

ACCESSIBILITY NOTES:

- MEANS OF EGRESS SHALL HAVE A MINIMUM CLEAR WIDTH OF 36".
- DOOR HARDWARE SHALL BE CAPABLE OF OPERATION WITH THE USE OF ONE (1) HAND AND SHALL NOT REQUIRE TIGHT GRASPING OR TWISTING OF THE HANDLE TO OPERATE. THUMBTURN DEADBOLTS ARE PROHIBITED. LEVEL OR PADDLE DEADBOLT RELEASES ARE ACCEPTABLE. DOOR THRESHOLD SHALL NOT EXCEED ONE-HALF (1/2") IN HEIGHT. THRESHOLDS EXCEEDING ONE-QUARTER (1/4") IN HEIGHT SHALL HAVE A 1/2" BEVEL. DOOR CLOSERS SHALL MEET OPENING FORCE AND SLEEP PERIOD REQUIREMENTS.
- HOT WATER, COLD WATER, AND DRAIN LINES UNDER SINKS AND LAVATORIES ARE TO BE INSULATED OR PROTECTED FROM ACCIDENTAL CONTACT.
- HANDICAPPED SIGNAGE AT THE TOILET ON THE WALL ADJACENT TO THE LATCH SIDE OF THE DOOR MEASURED 60" FROM THE CENTER OF THE SIGN TO THE FINISHED FLOOR.
- MIN. 4'-0" x 5'-0" FLAT AREA AT ALL EXTERIOR EXITS.
- CARPENTER CONTRACTOR TO FURNISH AND INSTALL ALL HARDWARE. PROVIDE LEVER-OPERATED MECHANISMS FOR ALL DOOR HARDWARE. DOOR OPENING FORCE TO COMPLY WITH ALL ACCESSIBILITY REQUIREMENTS. ALL DOOR LOCKS SHALL BE OPERABLE IN THE DIRECTION OF EXIT TRAVEL WITHOUT THE USE OF THE KEY OF ANY SPECIAL KNOWLEDGE.
- ALL MEANS OF EGRESS DOORS SHALL BE READILY OPENABLE FROM THE SIDE OF EGRESS WITHOUT USE OF KEYS, SPECIAL KNOWLEDGE OR EFFORT.
- ALL DOOR ASSEMBLIES IN FIRE RESISTANT RATED CONSTRUCTION SHALL BE FIRE RATED.
- ALL EGRESS DOORS SHALL BE EQUIPPED WITH APPROVED AUTOMATIC-CLOSING DEVICES.
- SELF-CLOSING FAUCETS FOR EACH LAV.
- THE DIAMETER OF THE GRAB BARS SHALL BE 1-1/2".
- THE SPACE BETWEEN THE WALL AND THE GRAB BARS SHALL BE 1-1/2".
- ROOM IDENTIFICATION AND NUMBERS SHALL HAVE TACTILE CHARACTERS. THEY SHALL BE PLACED ALONG THE LATCH SIDE OF THE DOOR AND MOUNTED 3'-0" ABOVE THE FLOOR.

DOOR SCHEDULE:
REFER TO SHEET A-4 FOR MORE INFORMATION

DOOR MARK:
DOOR
HARDWARE

DOORS:

- 3'-0" x 6'-8" INTERIOR SOLID CORE WOOD DOOR WITH RECESSED FLAT PANEL IN PAINTED HOLLOW METAL FRAME. EXACT DOOR SPECIFICATIONS TO BE DETERMINED BY OWNER.
- 3'-0" x 6'-8" - B LABEL, MINIMUM 1 HOUR RATED, INTERIOR STEEL DOOR AS MANUFACTURED BY SECURE-ALL OR OWNER APPROVED EQUAL. PROVIDE PAINTED HOLLOW METAL FRAME WITH CLOSER. EXACT DOOR SPECIFICATIONS TO BE DETERMINED BY OWNER.
- PAIR OF 3'-0" x 6'-8" INTERIOR SOLID CORE WOOD DOORS (LEFT LEAF TO BE FIXED) WITH TEMPERED GLASS PANELS AS SHOWN IN PAINTED HOLLOW METAL FRAME. EXACT DOOR SPECIFICATIONS TO BE DETERMINED BY OWNER.

HARDWARE:

- PUSH AND PULL HARDWARE WITH CLOSER
- PANIC HARDWARE AND CLOSER
- INTERIOR LOCKSET AND CLOSER
- PRIVACY LOCKSET AND CLOSER

NOTE: ALL EXIST. & NEW DOOR HARDWARE TO MEET ADA & IAC REQ'TS & IBC 1003.3.1.1 TO NOT NEED ANY SPECIAL KNOWLEDGE OR KEY TO EXIT SPACE

PARTITION LEGEND:
REFER TO SHEET A-4 FOR MORE INFORMATION

WALL TYPE "A"
3-5/8" METAL STUDS AT 16" o.c., SOUND ATTENUATION BATTS AND 5/8" GYP. BOARD ON EACH SIDE FROM FLOOR TO BOTTOM OF EXISTING STRUCTURE / DECK ABOVE. ALL VOIDS TO BE SEALED WITH AN ACOUSTICAL SEALANT.

NOTE: PROVIDE MOISTURE RESISTANT GYPSUM BOARD AS REQUIRED AT ALL TOILET ROOM WALLS.

WALL TYPE "B"
3-5/8" METAL STUDS AT 16" o.c., SOUND ATTENUATION BATTS, AND 5/8" MOISTURE RESISTANT GYP. BOARD ON EACH SIDE FROM FLOOR TO BOTTOM OF EXISTING STRUCTURE / DECK ABOVE.

WALL TYPE "C"
3-5/8" METAL STUDS AT 16" o.c. AND 5/8" MOISTURE RESISTANT GYP. BOARD ON EACH SIDE FROM FLOOR TO STRUCTURE ABOVE.

WALL TYPE "D" - ONE HOUR FIRE RATED
3-5/8" METAL STUDS AT 16" o.c., SOUND ATTENUATION BATTS, AND 5/8" GYP. BOARD ON EACH SIDE FROM FLOOR TO BOTTOM OF EXISTING STRUCTURE - 1 HOUR FIRE RATING, WALL DESIGN U, DES U404. ALL VOIDS TO BE SEALED WITH HILTI FS ONE FIRE STOP SEALANT OR EQUAL.

WALL TYPE "E"
1 1/2" METAL HAT CHANNELS AT 16"-24" o.c., FURRED OUT AT EXISTING WALL WITH 5/8" MOISTURE RESISTANT GYP. BOARD FROM FLOOR TO BOTTOM OF EXISTING STRUCTURE ABOVE.

PREPARED FOR:
TIVOLI ENTERPRISES

BUILDING:
109 W. SCHILLER COURT
ELMHURST, ILLINOIS

Project 12-154	K. Peterson Associates Architects
Date 11-16-12	315 Spring Ave. Naperville, Illinois 60540 630 548-1315
Revisions	Sheet 2 OF 4
	A-2

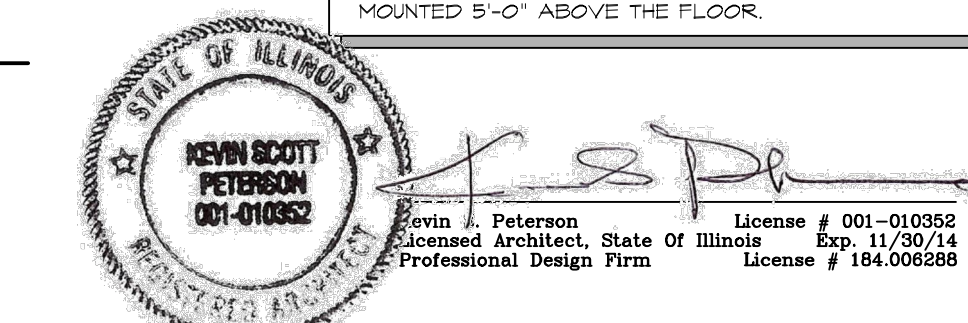

COPYRIGHT 2012 Kevin Peterson & Associates, INC.